

CareStart Rapid Antigen Testing (RAT) Test Procedure and Results Interpretation

What's in the RAT kit

- Swab
- Extraction vial
- Extraction cap
- Test device

What else you need

- Hand sanitiser
- Mask
- Gloves
- Biohazard waste bag

Procedure

1

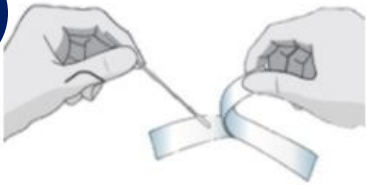

- Perform hand hygiene as per guidelines
- Place the test device on a flat surface
- Remove swab from packaging

2

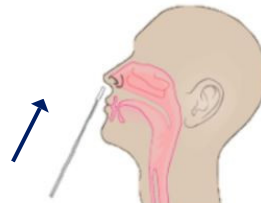

- Insert swab into one nostril until you feel a slight resistance (about 2-3cm)
- Slowly rotate swab **5 times** over the surface of the nasal passage
- Slowly remove swab from nostril while rotating it
- Repeat above on other nostril with same swab

3

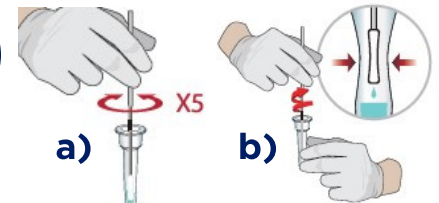

- Peel off the foil seal from extraction vial
- a) Place swab into vial and rotate the swab vigorously at least **5 times**
- b) Remove swab by rotating against vial
- Discard swab in biohazard waste bag

4



- Close the vial with the provided extraction cap and push firmly till you hear or feel a click
- Mix thoroughly by flicking the bottom of the vial

5



- Invert vial and hold the sample vertically above sample well
- Squeeze the vial gently and allow **3 drops** of the sample to fall into the well
- Read and interpret the results after **10 mins**

6

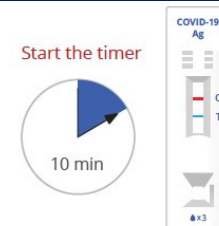

- Check your result using the back of the pamphlet
 - Dispose of your test kit following guidelines
 - Wash your hands when finished
- Note: test results should NOT be read and interpreted after 15 mins**

CareStart Rapid Antigen Testing (RAT) Test Procedure and Results Interpretation

Result Interpretation

Select the image that best represents your result on your Test Device by ticking the red circle.

Negative

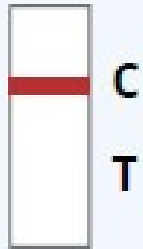

Positive

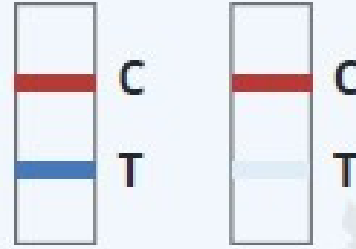

Invalid

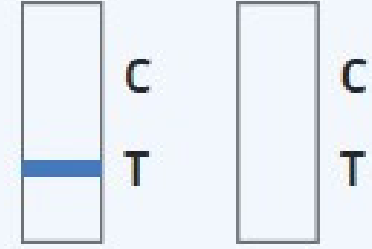

Action

- 1. Negative Test** - May indicate no infection. Follow procedure set up by local testing program.
- 2. Positive Test** - Follow procedure set up by local testing program.
- 3. Invalid Test** - Follow procedure set up by local testing program. It may be advised for you to repeat the test with a new kit with same sample or new sample.

Disposal of Test Kit Materials

All test kit materials are called biohazardous and can contain pathogens which can easily be transmitted to others. Please dispose of all used test kit materials in biohazard waste bag.

Tips



Do ensure proper hygiene at all times
Do check with your organisation's specific guidelines
Do use the QR code to access further information and resources
Do report any symptoms or positive results



Do not share equipment
Do not dispose of testing material in a normal waste bin
Do not take any test kit materials with you
Do not leave test kit materials lying around